

STRATIGRAPHIC TRAP: DELINEATION OF AN OIL-BEARING RESERVOIR

Red River County, Texas, USA



AGI Survey area

Geology:

- Braided Valley Fill
- Target: Upper Jurassic Louark age alluvial fan – 5800 feet
- Located unconformably on the Paleozoic and Triassic structural front of the buried Ouachita Range
- Oil is stratigraphically trapped

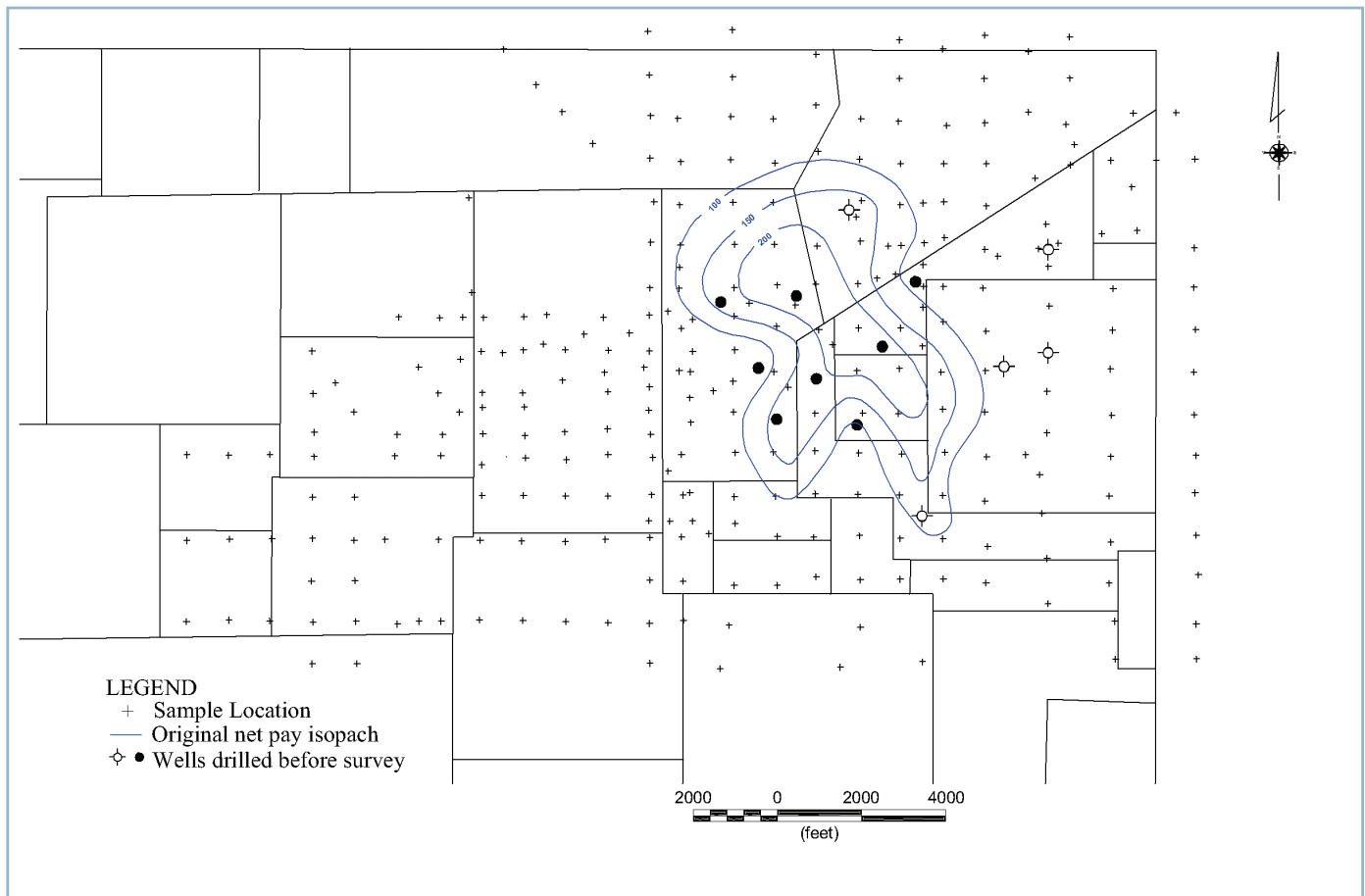

Map showing the AGI Survey grid and the client's original net pay isopach

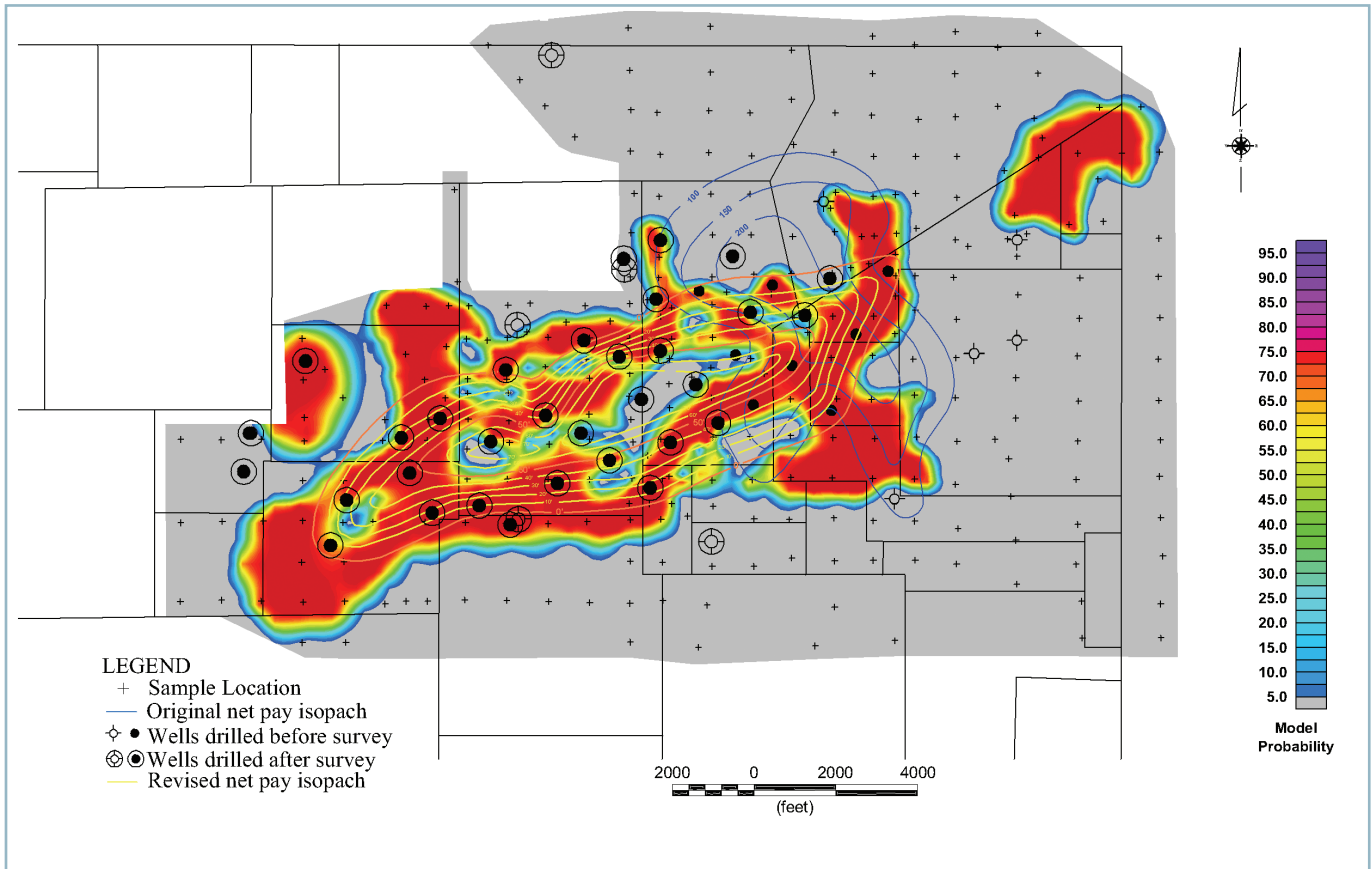

AGI Survey results showing high probability areas for finding oil, and clients revised net pay isopach

Survey Summary

- 550 grid samples in 3 phases
- 400 – 600 ft grid spacing
- 11 mi² coverage

Survey Results

- AGI Survey results correctly redefined field trend - Pre-survey geologic and seismic interpretation indicated the trend of deposition to be in a NW to SE direction. The AGI Survey indicated the trend was NE to SW, which was confirmed by drilling.
- Of the 26 wells drilled in areas identified by the AGI Survey as high-probability for oil: 25 are/were oil wells and one is a dry well
- Of the nine wells drilled in areas identified by the AGI Survey as low-probability for oil: three are dry wells and six are/were oil wells
- Overall 80% success rate!